

<b>Bike</b>	Suzuki GSX-8R	<b>Part No.</b>	RSI-130-SYS
<b>Year</b>	2024-Current	<b>Fit Kit</b>	Z039.10746
<b>Notes</b>	Where not supplied use original fittings.	<b>dB Killer</b>	SCEXDBK24 - (TYPE W)

Estimated Fitting Time: 60 Minutes

Secure Bracket to  
Rear of Footrest  
Support

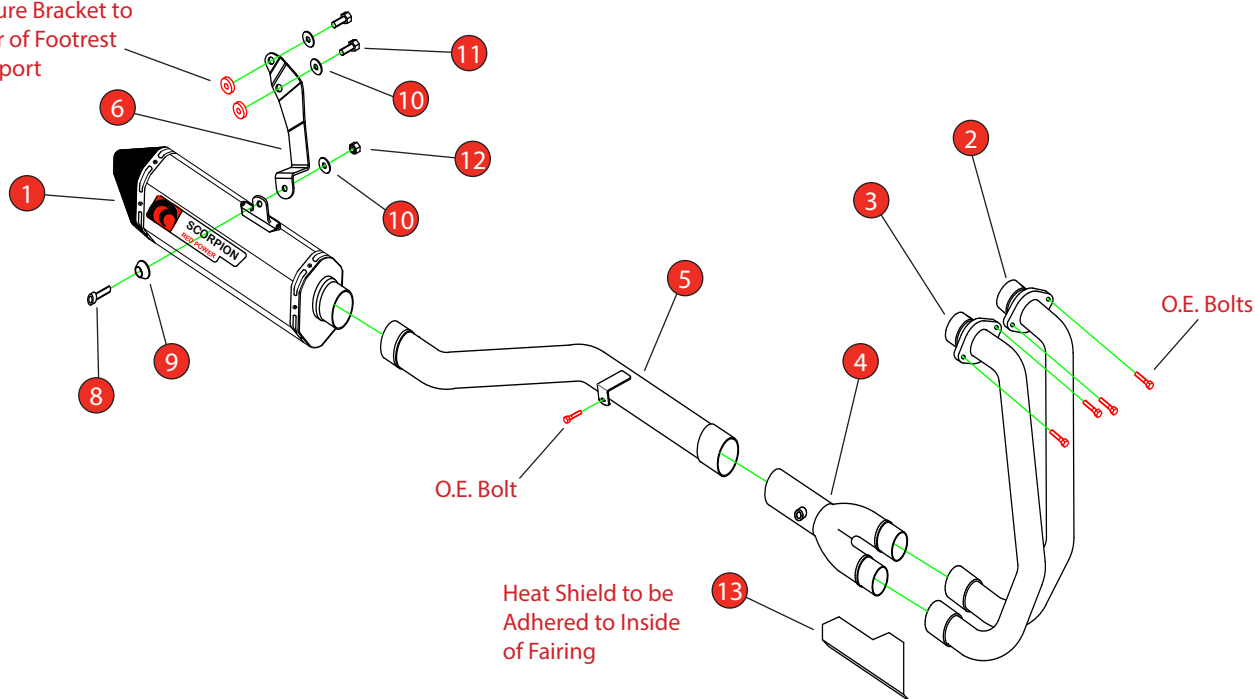

NO.	PART NO.	DESCRIPTION	QTY
1	RSC532	Serket Parallel Silencer	1
2	CP1202	L/H Header Pipe	1
3	CP1203	R/H Header Pipe	1
4	CP1204	Collector Pipe	1
5	CP1205	Link Pipe	1
<b>Fit Kit - Z039.10746</b>			
6	Z007.31720	Silencer Support Bracket	1
7	Z017.12732	Cable Tie (Not Shown)	1
8	Z017.10808	M8 x 16mm Cap Head Screw	1
9	Z026.20068	Alloy Bolt Finisher	1
10	Z017.10831	M8 x 17mm Washer	3
11	Z017.10043	M8 x 16mm Hex. Screw	2
12	Z017.10062	M8 Nyloc Nut	1
13	Z028.20440	Fairing Heat Shield	1

CLASSIFICATION	Closed Circuit Product
HOMOLOGATED	NO
DATE	20/08/2024
ISSUE	00
AUTHORISED	G. O'Shea

**NOTE:** ENSURE SCORPION SYSTEM IS CLEAR OF MOVING PARTS AND ALL ORIGINAL FUNCTIONS WORK CORRECTLY.



STAY CONNECTED TO RED POWER.

<b>Bike</b>	Suzuki GSX-8R	<b>Part No.</b>	RSI-130-SYS
<b>Year</b>	2024-Current	<b>Fit Kit</b>	Z039.10746
<b>Notes</b>	Where not supplied use original fittings.	<b>dB Killer</b>	SCEXDBK24 - (TYPE W)



A) Remove the 4 plastic clips from the front chin panel.

B) Remove the chin panel from the bike.

C & D) On the right side of the bike, remove the lower fairing bolts.

E) Remove the upper fairing bolt.

F) Remove the 2 bolts from the top of the upper fairing.

G) Remove the 3 push clips from the panel below the headlight.



H) Carefully pull the fairing away from the bike to get to the indicator wiring.





<b>Bike</b>	Suzuki GSX-8R	<b>Part No.</b>	RSI-130-SYS
<b>Year</b>	2024-Current	<b>Fit Kit</b>	Z039.10746
<b>Notes</b>	Where not supplied use original fittings.	<b>dB Killer</b>	SCEXDBK24 - (TYPE W)

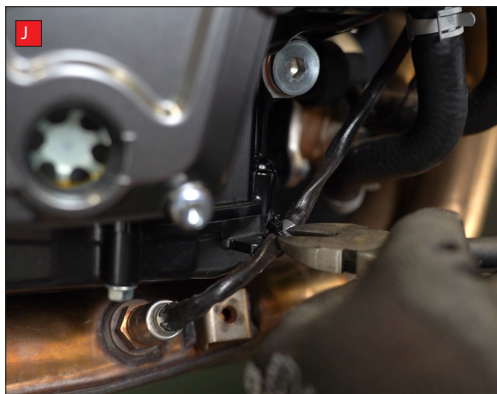

I) Disconnect the indicator wiring at the plug, you can then remove the fairing from the bike and put in a safe place.

J) Cut the cable tie that's securing the lambda sensor cable to the engine.

K) Disconnect the lambda sensor plug behind the radiator.

L) Un-clip the wiring from the radiator support bracket.

M) Remove the lambda sensor.

N) Completely remove the radiator support bracket.

O) Remove the header bolts.

P) On the left side of the bike, remove the exhaust mounting bolt.





<b>Bike</b>	Suzuki GSX-8R	<b>Part No.</b>	RSI-130-SYS
<b>Year</b>	2024-Current	<b>Fit Kit</b>	Z039.10746
<b>Notes</b>	Where not supplied use original fittings.	<b>dB Killer</b>	SCEXDBK24 - (TYPE W)



Q) On the right side of the bike support the weight of the exhaust and remove the mounting bolt.

R) Carefully remove the exhaust from the bike.

S) Loosely install the Scorpion headers using the original header bolts. You will fully tighten them in a later step.

T) Slide the collector onto the headers with the lambda sensor boss facing outwards.



U) Slide the connecting pipe onto the collector and align the bracket with the mounting point on the frame.

V) Secure in place with the original mounting bolt. Leave loose for now, you will fully tighten in a later step.

W) Attach the silencer mounting bracket to the back of the rear foot rest using the supplied hardware. Do not fully tighten yet, you will do this in a later step.



X) Slide the Scorpion silencer onto the connecting pipe and align with the mounting bracket.





<b>Bike</b>	Suzuki GSX-8R	<b>Part No.</b>	RSI-130-SYS
<b>Year</b>	2024-Current	<b>Fit Kit</b>	Z039.10746
<b>Notes</b>	Where not supplied use original fittings.	<b>dB Killer</b>	SCEXDBK24 - (TYPE W)

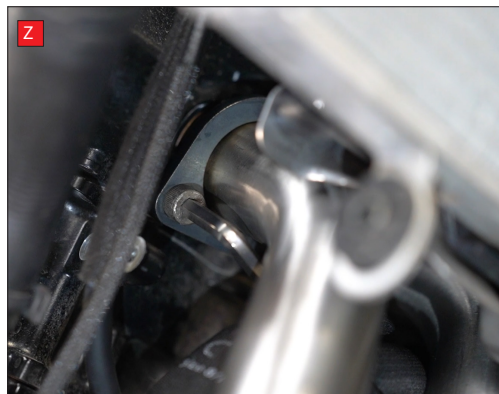

Y) Secure in place with the supplied hardware. Do not fully tighten yet, you will do this in a later step.

Z) Adjust the exhaust system so that it fits correctly and is away from any moving parts then fully tighten the header bolts.

**NOTE: It's important that you tighten the bolts evenly to ensure the collars seat correctly against the gaskets in the head.**

AA) Fully tighten the connecting pipe mounting bolt.



AB) Fully tighten the silencer mounting hardware.

AC) Fully tighten the silencer mounting bracket bolts.

AD) Re-install the radiator support bracket.

AE) Screw the lambda sensor into the boss and fully tighten.

AF) Feed the lambda cable along its original route and plug back into its connector behind the radiator. Clip the cables back into the radiator support bracket.

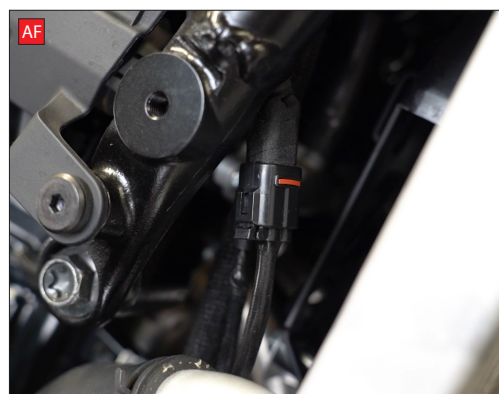
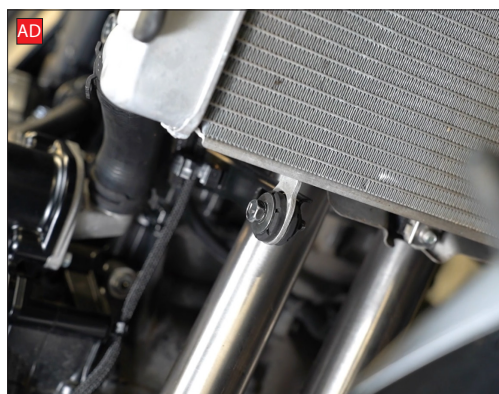



<b>Bike</b>	Suzuki GSX-8R	<b>Part No.</b>	RSI-130-SYS
<b>Year</b>	2024-Current	<b>Fit Kit</b>	Z039.10746
<b>Notes</b>	Where not supplied use original fittings.	<b>dB Killer</b>	SCEXDBK24 - (TYPE W)

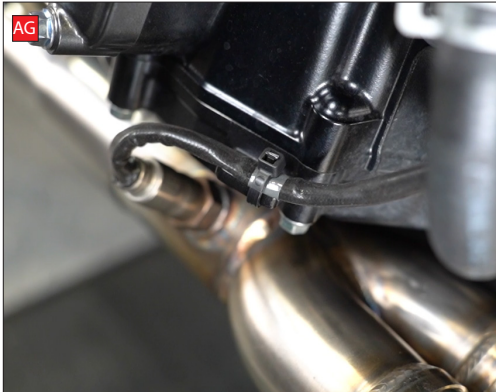

AG) Secure the lambda sensor cable to the engine with the supplied cable tie.

AH) place the fairing on a soft clean surface and install the self adhesive heat tape on the inside as shown.

AI) Bring the fairing over to the bike and reconnect the indicator wiring.

AJ) Place the fairing back into position on the bike.

AK) Refit all the original mounting bolts for the fairing.



AL) Re-attach the plastic panel below the headlight using the original push clips.

AM) Re-install the front chin panel using the original push clips.

When fitted take bike for a short ride to ensure all functions are correct. When bike & exhaust are cool enough check all nuts and bolts are still secure.



<b>Bike</b>	Suzuki GSX-8R	<b>Part No.</b>	RSI-130-SYS
<b>Year</b>	2024-Current	<b>Fit Kit</b>	Z039.10746
<b>Notes</b>	Where not supplied use original fittings.	<b>dB Killer</b>	SCEXDBK24 - (TYPE W)

Estimated Fitting Time: 60 Minutes



Thank you for purchasing your Scorpion Silencer.

Care of your exhaust: Please refrain from cleaning silencer with heavy solvents or abrasives!

Vielen Dank Für den kauf eines Scorpion Schalldampfers! Pflegehinweis: Bitte verwenden Sie niemals Scheuermittel oder aggressive Reiniger zur Pflege Ihres Auspuffes!

Merci d'avoir choisi un echappement Scorpion.

Entretien de votre silencieux: Ne pas utiliser de solvants ou de produits abrasifs!

Muchas gracias por adquirir un Silencioso Scorpion. Le recomendamos no limpiar el silencioso con productos abrasivos o aquellos que contengan disolventes.



STAY CONNECTED TO RED POWER.