

Bike	KTM Duke 390	Part No.	PKT-83
Year	2017-2020	Fit Kit	Z039.10614
Notes	Where not supplied use original fittings	dB Killer	SCEXDBK47 - (Type PB)

Estimated Fitting Time: 30 Minutes

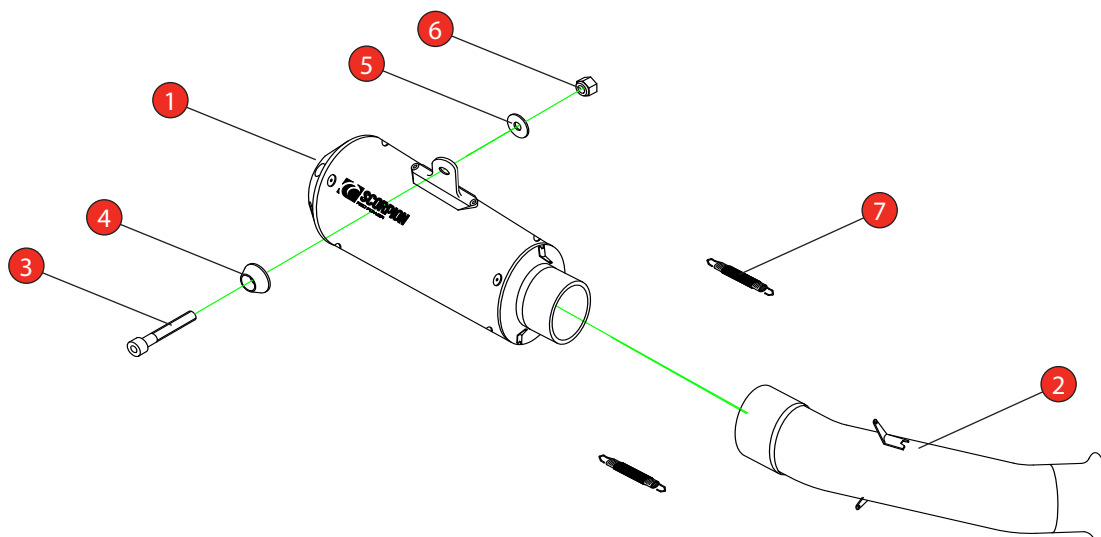

NO.	PART NO.	DESCRIPTION	QTY
1	PSC459	Red Power Silencer	1
2	CP956	Connecting Pipe	1
Fit Kit - Z039.10614			
3	Z017.10076	M8 x 40mm Cap Head Bolt	1
4	Z026.20068	Alloy Bolt Finisher	1
5	Z017.10825	M8 x 25mm Washer	1
6	Z017.10062	M8 Nyloc Nut	1
7	Z028.10030	Rubber Coated Spring	2

CLASSIFICATION	Closed Circuit Product
HOMOLOGATED	No
DATE	21/11/2022
ISSUE	00
AUTHORISED	S Shipley

NOTE: ENSURE SCORPION SYSTEM IS CLEAR OF MOVING PARTS AND ALL ORIGINAL FUNCTIONS WORK CORRECTLY.



STAY CONNECTED TO RED POWER.

Bike	KTM Duke 390	Part No.	PKT-83
Year	2017-2020	Fit Kits	Z039.10614
Notes	Where not supplied use original fittings	dB Killer	SCEXDBK47 - (Type PB)

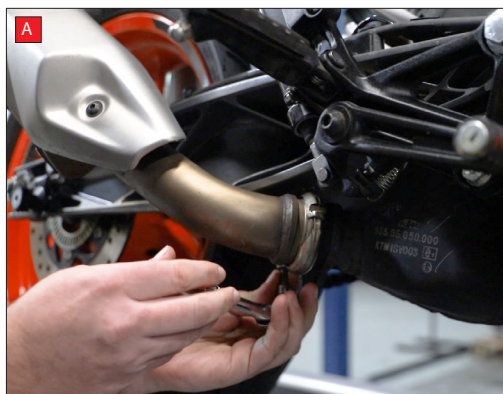

A) Start by removing the clamp between the rear silencer and centre silencer.

B) Loosen the rear silencer mounting bolt.

C) Support the weight of the silencer then remove the mounting bolt. You can now carefully remove the silencer from the bike.

D) Slide the Scorpion connecting pipe over the outlet of the centre silencer, reuse the original gasket if it is in good condition or replace with a genuine KTM gasket if it's not. Attach in place with the original clamp but leave it slightly loose at this point to allow for adjustment. You will tighten it in a later step.

E) Slide the Scorpion silencer onto the connecting pipe and secure in place with the supplied mounting hardware. Again you should leave loose at this stage to allow for adjustment.

F) Install the springs between the silencer and the connecting pipe.

G) Adjust the system so that it sits nicely, under no tension and clear of any moving parts, then fully tighten the clamp between the centre silencer and the Scorpion connecting pipe.

H) Fully tighten the silencer mounting bolt.

Take the bike for a short ride to ensure it functions as it should. Once the bike and exhaust are cool enough check all nuts and bolts are still secure.



Bike	KTM Duke 390	Part No.	PKT-83
Year	2017-2020	Fit Kit	Z039.10614
Notes	Where not supplied use original fittings	dB Killer	SCEXDBK47 - (Type PB)

Estimated Fitting Time: 30 Minutes



Thank you for purchasing your Scorpion Silencer.

Care of your exhaust: Please refrain from cleaning silencer with heavy solvents or abrasives!

Vielen Dank Für den kauf eines Scorpion Schalldampfers! Pflegehinweis: Bitte verwenden Sie niemals Scheuermittel oder aggressive Reiniger zur Pflege Ihres Auspuffes!

Merci d'avoir choisi un echappement Scorpion.

Entretien de votre silencieux: Ne pas utiliser de solvants ou de produits abrasifs!

Muchas gracias por adquirir un Silencioso Scorpion. Le recomendamos no limpiar el silencioso con productos abrasivos o aquellos que contengan disolventes.



STAY CONNECTED TO RED POWER.