

BIKE	YAMAHA YZF 600 R6	PART NO.	YA-1000
YEAR	2006 - Current	FIT KITS	Z039.10390
NOTES	Use standard fittings where not supplied Remove standard gasket if fitted.	FEATURES	DB KILLER Z38.10530 (EE)

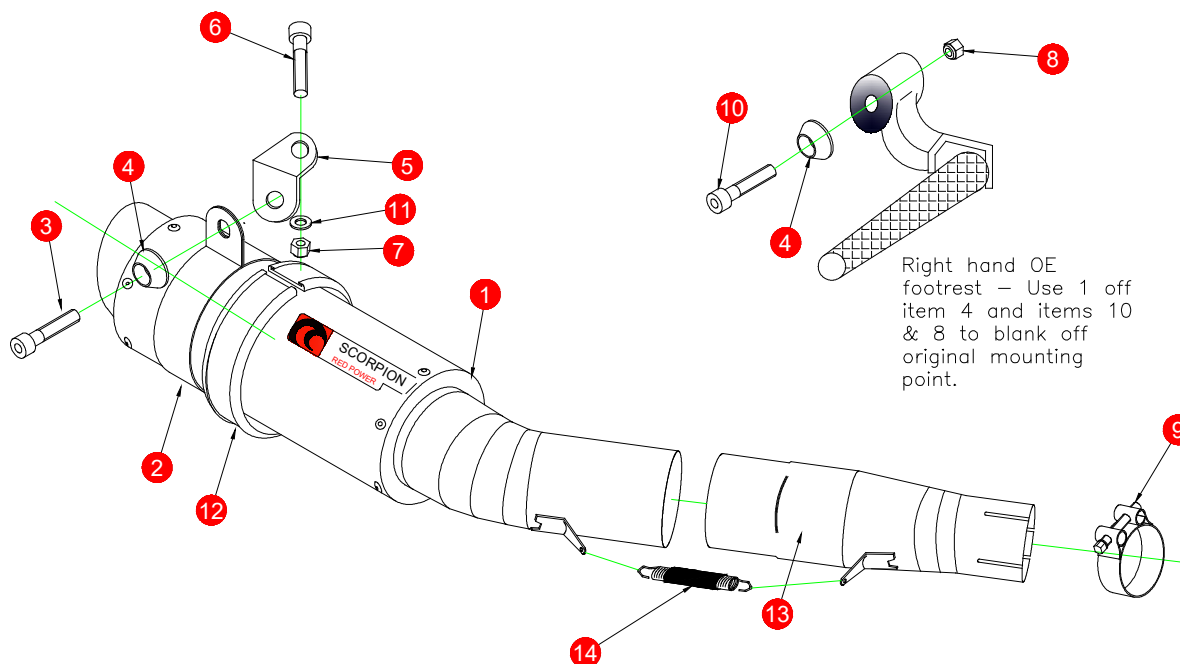

- 1 225mm RP-1 GP Silencer with integrated CP 582
- 2 Titanium Silencer Strap (Z028.10013)
- 3 M8x12mm Cap Head Bolts (Z017.10070)
- 4 2 off Bolt Finishers (Z026.20068)
- 5 Mounting Bracket (Z015.10080)
- 6 M6x40mm Cap Head Bolt (Z017.10022)
- 7 M6 Nyloc Nut (Z017.10033)
- 8 M8 Nyloc Nut (Z017.10062)

- 9 47-51mm Band Clamp (Z016.10003)
- 10 M8x30mm Cap Head Bolt (Z017.10074)
- 11 M6 Washer (Z017.10617)
- 12 Square edge rubber (Z029.10024)
- 13 Connecting Pipe CP838
- 14 Rubber Coated Spring (Z028.10030)
- 15 100mm Cable Tie (Z017.12732)

E-MARK	e4 2217
ISSUE NO.	7
DATE	22/0716
AUTHORISED	S.Jackson
CHECKED	

NOTE: ENSURE SCORPION SYSTEM IS CLEAR OF MOVING PARTS AND ALL ORIGINAL FUNCTIONS WORK CORRECTLY.



A) Remove original exhaust from bike, taking care to keep all original components in a safe place.

B) Refit Scorpion exhaust as per line diagram above.

C) When fitted take bike for a short ride to ensure all functions are correct.

D) When bike & exhaust are cool enough check all nuts and bolts are still secure.

BIKE	YAMAHA YZF 600 R6	PART NO.	YA-1000
YEAR	2006 - Current	FIT KITS	Z039.10390
NOTES	Use standard fittings where not supplied Remove standard gasket if fitted.	FEATURES	DB KILLER Z38.10530 (EE)

CONTINUED FROM OVERLEAF:

A



B



A) Remove lower fairing bolt to aid access to OE silencer clamp

B) Remove the three bolts shown to expose the exup valve & cables

C) Disconnect the cables by unscrewing the adjusting nuts & lift the nipples out of the wheel

You can now remove the OE silencer by removing the clamp & top hanging bolt

C



D



D) Before fitting the Scorpion silencer, use the cable-tie to safely attach the loose cables to the lambda sensor wire & trim the cable-tie.

E) Now remove the O.E flare and gasket from the exhaust to Scorpion product can fit the O.E.

F) Fit the Scorpion silencer with the new clamp & bolt and fasten securely with the Nyloc nut, then tighten the clamp. As shown in the line diagram.

E



F



Ensure all cables and any fitments are secured safely and all original functions work correctly prior to use.