

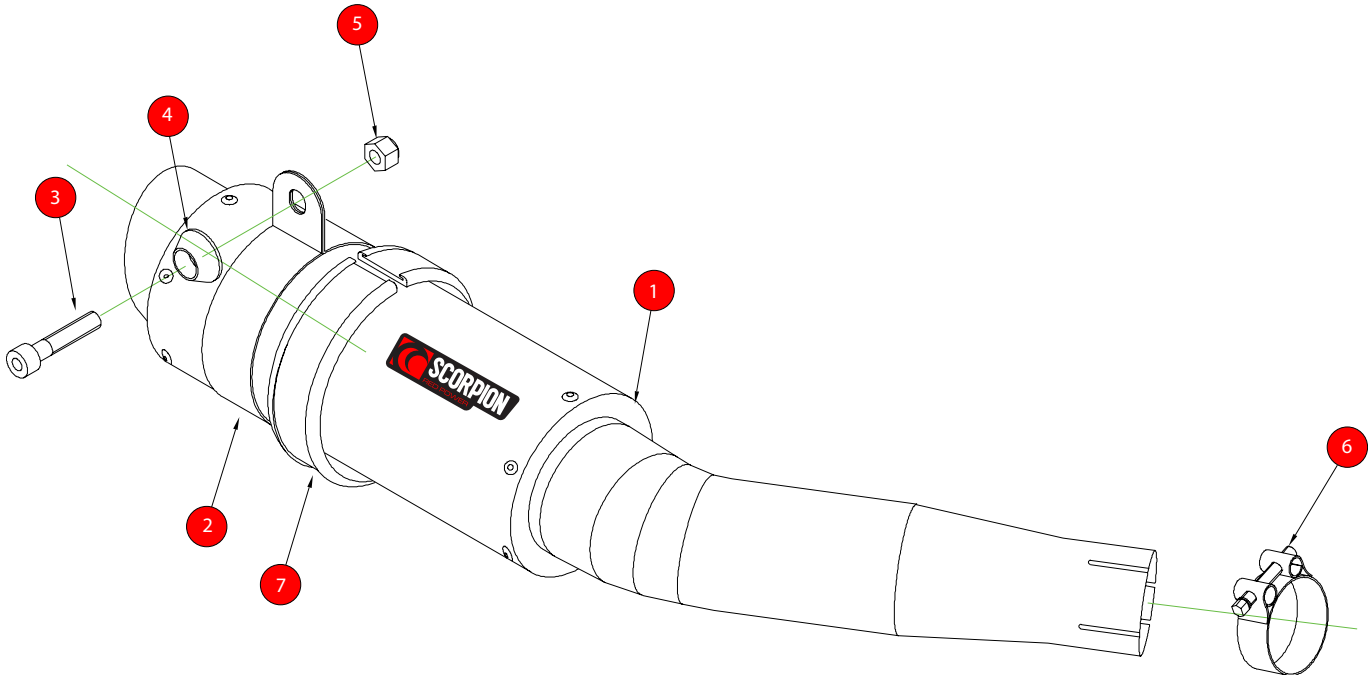

Box: PLOCK 1

BIKE	SUZUKI GSXR 600/750	PART NO.	SI-1001
YEAR	2008 - 2010	FIT KITS	ROUND Z039.10370
NOTES	Use standard fittings where not supplied Remove standard gasket if fitted.	FEATURES	Db Killer:- Z038.10530 (EE)



- 1 225mm RP-1 GP Silencer with intergrated CP 564
- 2 Titanium Silencer Strap (Z028.10013)
- 3 M8x40mm Cap Head Bolt (Z017.10076)
- 4 1 Alloy Bolt Finishers (Z026.20068)
- 5 M8 Nyloc nut (Z017.10062)
- 6 47-51mm Band Clamp (Z016.10003)
- 7 Square edge rubber (Z029.10024)

E-MARK	SI-102  2275 
ISSUE NO.	2
DATE	16/11/11
AUTHORISED	S.PEPPER
CHECKED	

**NOTE:** ENSURE SCORPION SYSTEM IS CLEAR OF MOVING PARTS AND ALL ORIGINAL FUNCTIONS WORK CORRECTLY.



- A) Remove original exhaust from bike, taking care to keep all original components in a safe place.
- B) refit Scorpion exhaust as per line diagram above.
- C) When fitted take bike for a short ride to ensure all functions are correct.
- D) When bike & exhaust are cool enough check all nuts and bolts are still secure.