

Box: PLOCK 1

BIKE	SUZUKI SV 650	PART NO.	ESI - 75
YEAR	03	FIT KITS	OVAL Z039.11082 // ROUND Z039.10082
NOTES	Item 7 required to re-fit OE exhaust system	FEATURES	DB KILLER Z038.10120

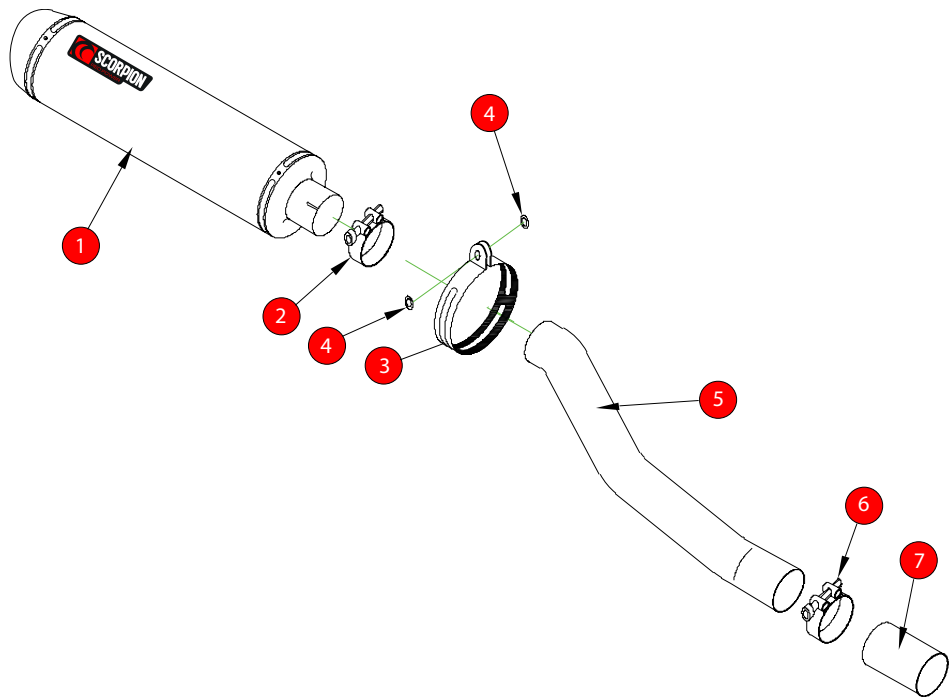

- |   |                                 |
|---|---------------------------------|
| 1 450mm Silencer ESC 94                                 | 8 Original Silencer Cut Diagram |
| 2 51-55mm Band Clamp (Z016.10002)                       |                                 |
| 3 Composite Silencer Strap (R-Z038.10089)(O-Z038.10088) |                                 |
| 4 2 x M8 x 25mm Washers (Z017.10825)                    |                                 |
| 5 Connecting Pipe CP 325                                |                                 |
| 6 55-59mm Band Clamp (Z016.10004)                       |                                 |
| 7 Re-connecting Sleeve CP327                            |                                 |

E-MARK	SCDB-UC [e4] 2106
ISSUE NO.	13
DATE	07/08/09
AUTHORISED	S.Northrop
CHECKED	

**NOTE:** ENSURE SCORPION SYSTEM IS CLEAR OF MOVING PARTS AND ALL ORIGINAL FUNCTIONS WORK CORRECTLY.



A) Remove original exhaust from bike, taking care to keep all original components in a safe place.

B) Refit Scorpion exhaust as per line diagram above.

C) When fitted take bike for a short ride to ensure all functions are correct.

D) When bike & exhaust are cool enough check all nuts and bolts are still secure.

