

Box: PLOCK 1

BIKE	SUZUKI GSF 600 / 650 / 1200 BANDIT. CARBINE	PART NO.	ESI - 90
YEAR	2000 - 2006	FIT KITS	OVAL Z039.11081
NOTES	Where not supplied use original fittings	FEATURES	DB KILLER Z038.10120

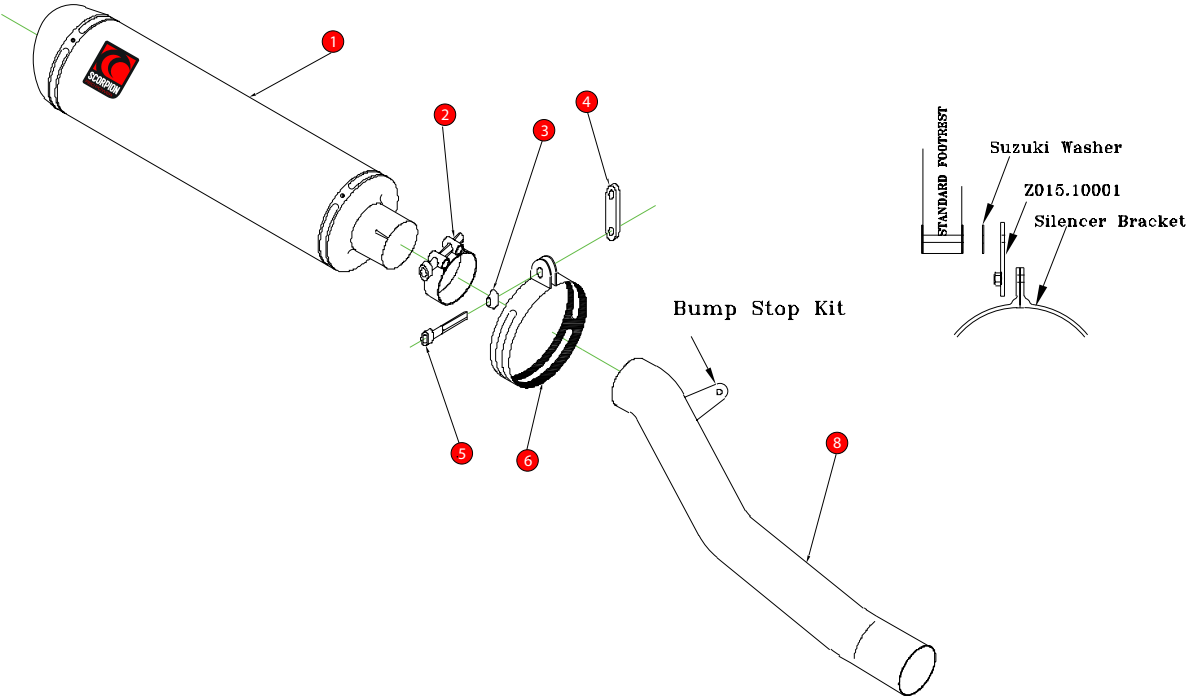

1 225mm Silencer ESC 114	8 Bump Stop Kit
2 51-55mm Band Clamp (Z016.10002)	
3 Alloy Bolt Finisher (Z026.20068)	
4 Mounting Bracket (Z015.10001)	
5 M8 x 16mm Cap Head Bolt (Z017.10808)	
6 Composite Silencer Strap (O-Z038.10088)	
7 Connecting Pipe CP33	

E-MARK ROUND	
E-MARK OVAL	BSAU 193a 1990/t3
ISSUE NO.	8
DATE	19/12/08
AUTHORISED	S.Northrop
CHECKED	

NOTE: ENSURE SCORPION SYSTEM IS CLEAR OF MOVING PARTS AND ALL ORIGINAL FUNCTIONS WORK CORRECTLY.



- A) Remove original exhaust from bike, taking care to keep all original components in a safe place.
- B) Refit Scorpion exhaust as per line diagram above.
- C) When fitted take bike for a short ride to ensure all functions are correct.
- D) When bike & exhaust are cool enough check all nuts and bolts are still secure.